



Crystal Medical Center

5700 Bottineau Blvd, Crystal, MN 55429

Building Size:
44,865 sq. ft.

Space Available:
5,274 sq. ft.

- Dense area demographics
- Superior access and visibility
- Strong signage opportunities on County Road 81
- Free conference room available to tenants
- 5/1000 parking ratio allowing ample parking for patients, staff and physicians
- Lease incentives available

Anne E. Madyun CCIM
612.454.4172
amadyun@davishre.com
davishre.com

Jill K. Rasmussen CCIM, SIOR
612.341.3247
jasmussen@davishre.com

T

BUILDING TENANTS



NORTHWEST
FAMILY
CLINICS



COMFORTABLE
DENTAL



NovaCare
REHABILITATION

**NYSTROM &
ASSOCIATES, LTD.**



TRAFFIC COUNT

19,700 vehicles on County Road 81 A.A.D.T.
(average annual daily traffic)
16,400 vehicles on Bass Lake Road



2023 ESTIMATED POPULATION

1 mile: 11,214
3 miles: 111,459
5 miles: 285,207



2023 ESTIMATED AVERAGE HOUSEHOLD INCOME

1 mile: \$85,710
3 miles: \$89,717
5 miles: \$100,830



PHYSICIANS REALTY TRUST



Crystal Medical Center

5700 Bottineau Blvd, Crystal, MN 55429

FLOOR PLAN
(1ST FLOOR)

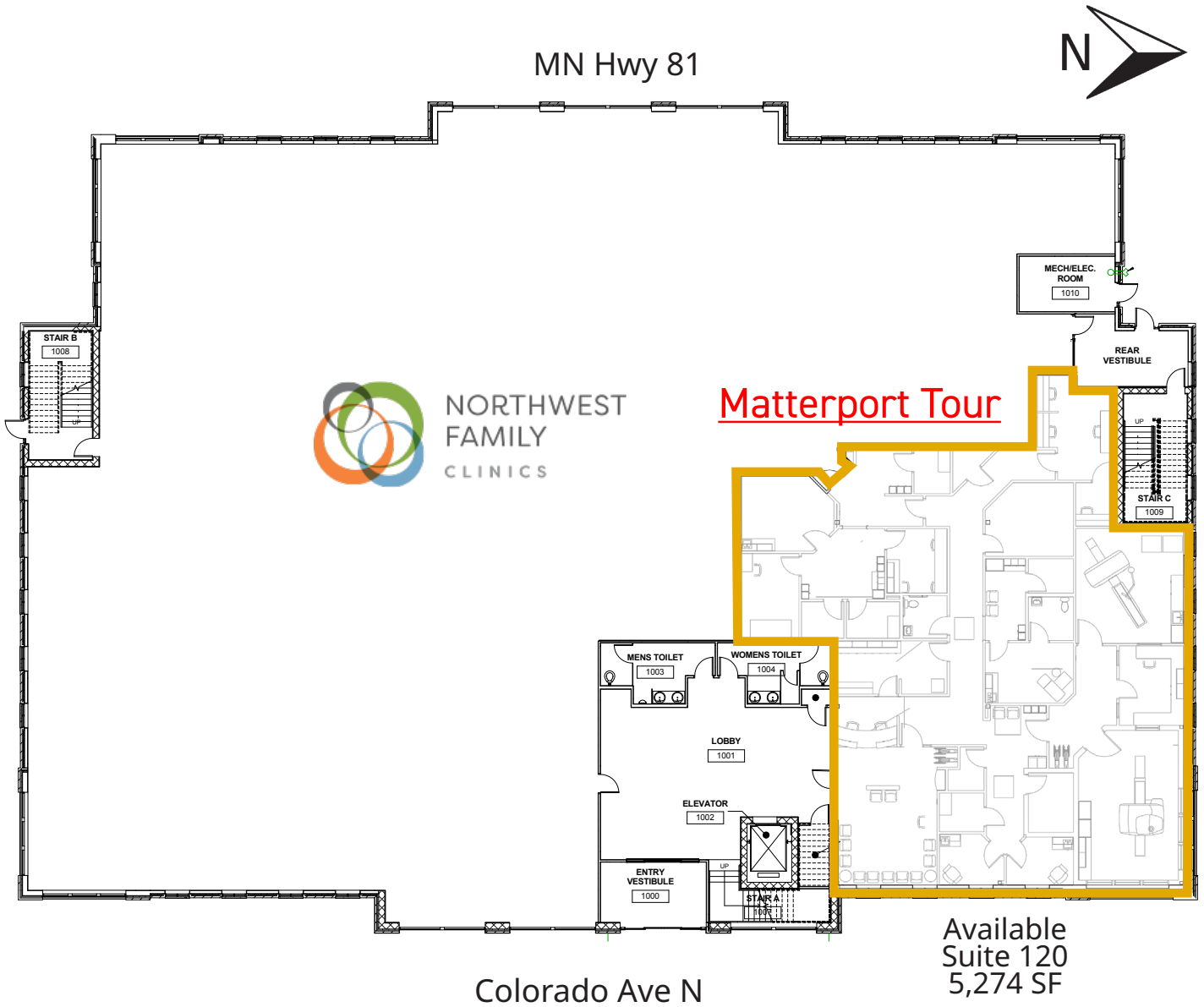



Crystal Medical Center

5700 Bottineau Blvd, Crystal, MN 55429

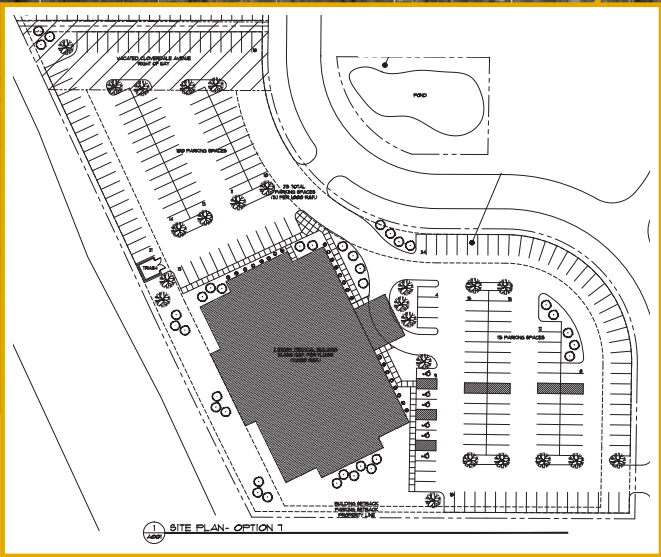
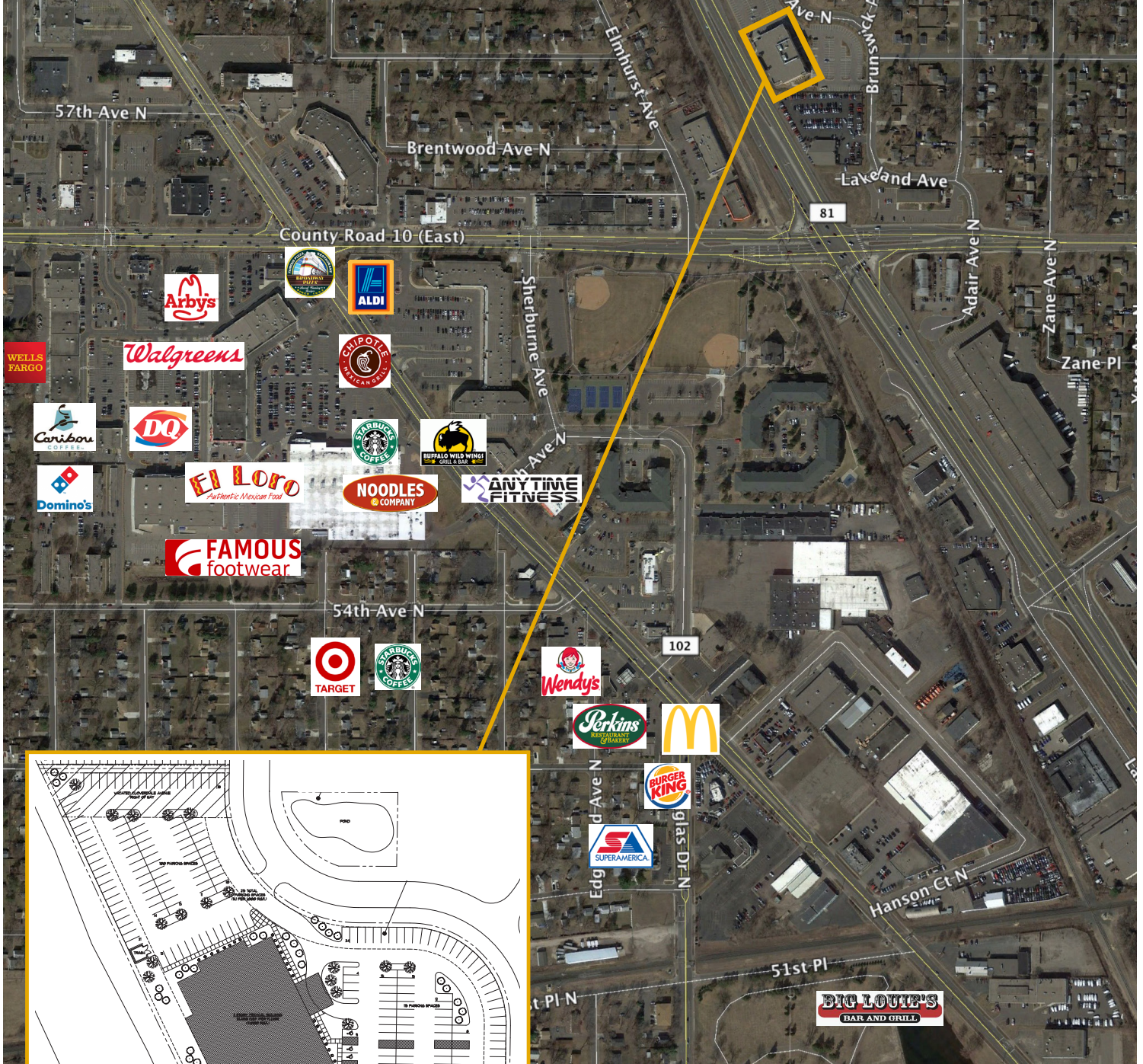



Crystal Medical Center

5700 Bottineau Blvd, Crystal, MN 55429

